

**BUDGETARY INSTITUTION OF CULTURE OF OMSK REGION
«OMSK STATE ACADEMIC DRAMA THEATRE»**

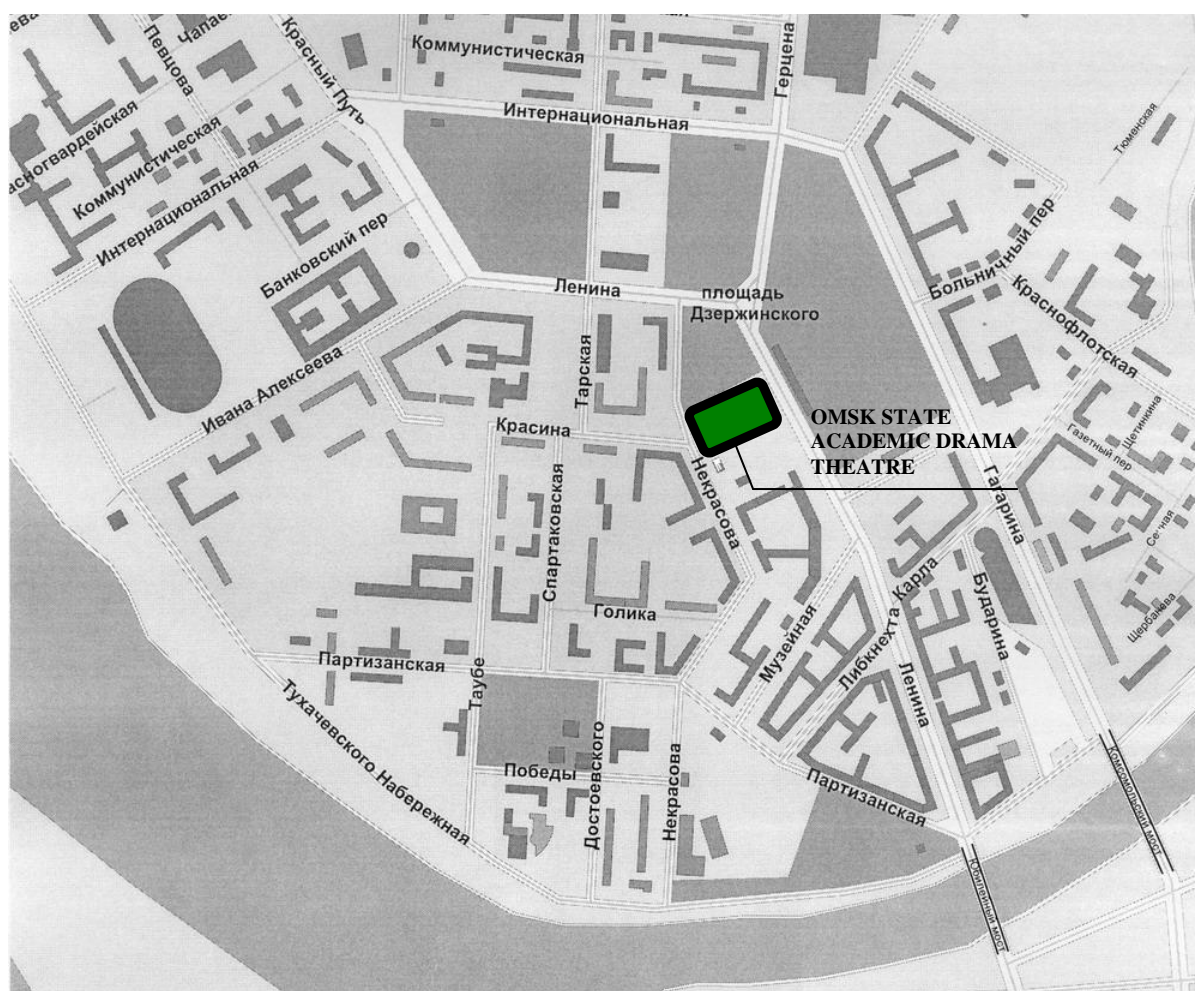

WAY-FINDING MAP

«OMSK STATE ACADEMIC DRAMA THEATRE»

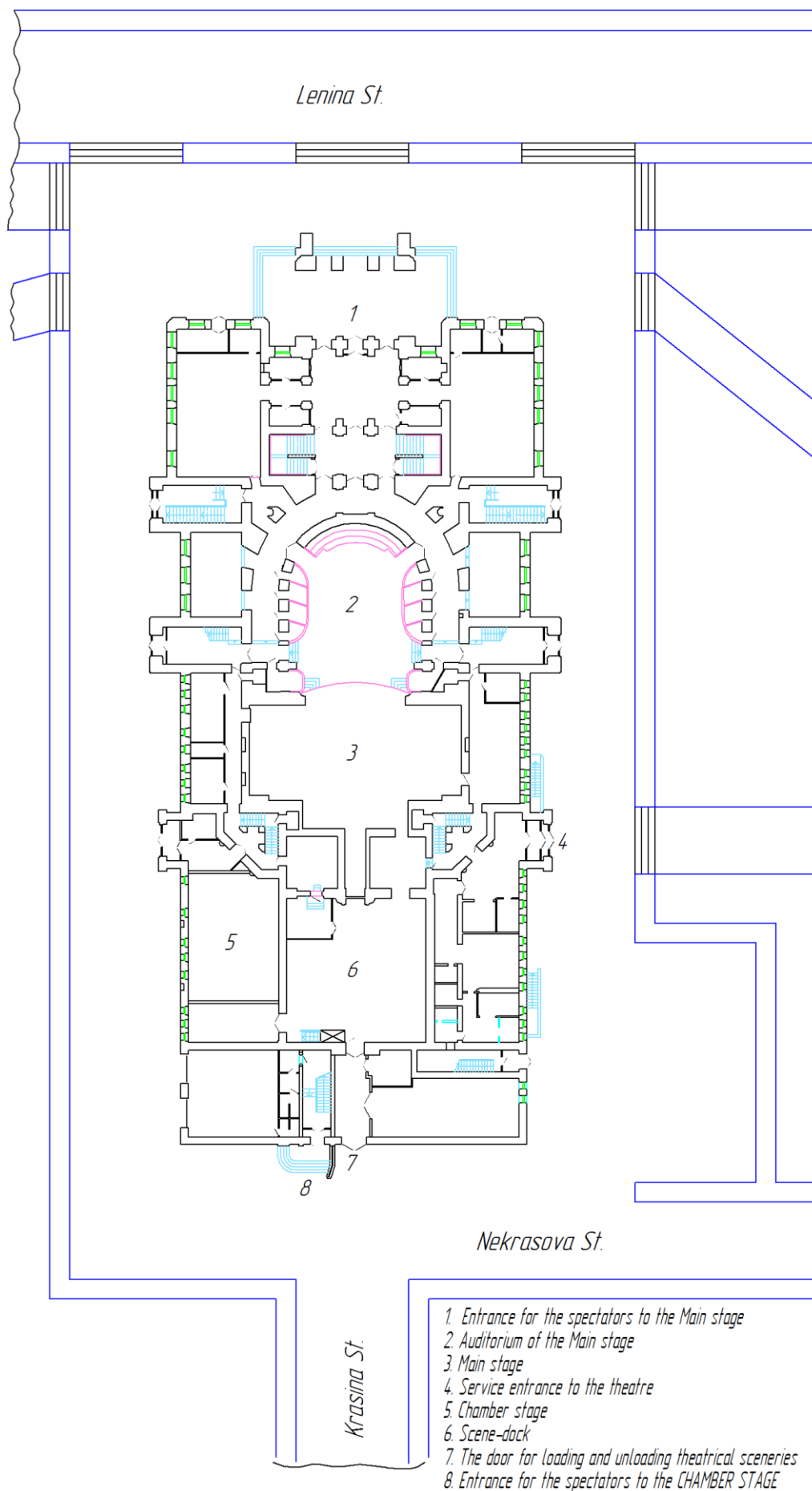

PHONE LIST
«OMSK STATE ACADEMIC DRAMA THEATRE»

<i>Position held</i>	<i>Full name</i>	<i>Office phone</i>
General manager	Byvalin Mir	23-47-96
Theatre director	Tskhviravashvili Georgy	25-27-35
Deputy Director of Art and Technical parts	Apanasevich Grigory	24-40-07
Deputy Director of Audience services	Astasheva Valentina	24-32-12
Deputy Director of Engineering services	Pavlov Konstantin	23-84-22
Deputy Director of Finance	Pronina Elena	23-51-50
Literary director	Vegeley Svetlana	24-40-18
Chief administrative officer	Kelep Tatyana	24-39-62
Company director	Trandina Liubov	24-32-28
Editor	Kuzmina Svetlana	24-40-18
Head of Procurement	Valiev Rinat	23-49-70
Head of HR Department	Pavlova Natalya	24-39-98
Technical director	Revyakin Andrey	24-40-07
Sound designer	Gordeev Alexander	134 / 262 (inter)
Head of decorating shop	Kashirina Natalya	255 (inter)
Head of scene shop	Kiriluk Vladislav	118 (inter)
Head of sewing shop	Tsvetkova Evgenya	120 (inter)
Head of joiner shop	Matveuk Dmitry	133 (inter)
Head of carpenter shop	Podrezov Oleg	259 (inter)
Wardrobe Supervisor	Ramenskaya Liudmila	121 / 249 (inter)
Property-manager	Reznik Natalya	251 (inter)
Hair & Wig Supervisor	Shipovalova Svetlana	159 (inter)
Head of museum	Eskina Julia	139 (inter)

Connection with internal lines by phones:

(3812) 23-55-31 – reception desk

(3812) 23-47-96 – inner office

Address: 8A Lenina St., Omsk, 644099, Russia

Fax: (3812) 24-39-26

E-mail: oad@mail.ru

Website: www.omskdrama.ru

CHAMBER STAGE
«OMSK STAGE ACADEMIC DRAMA THEATRE»

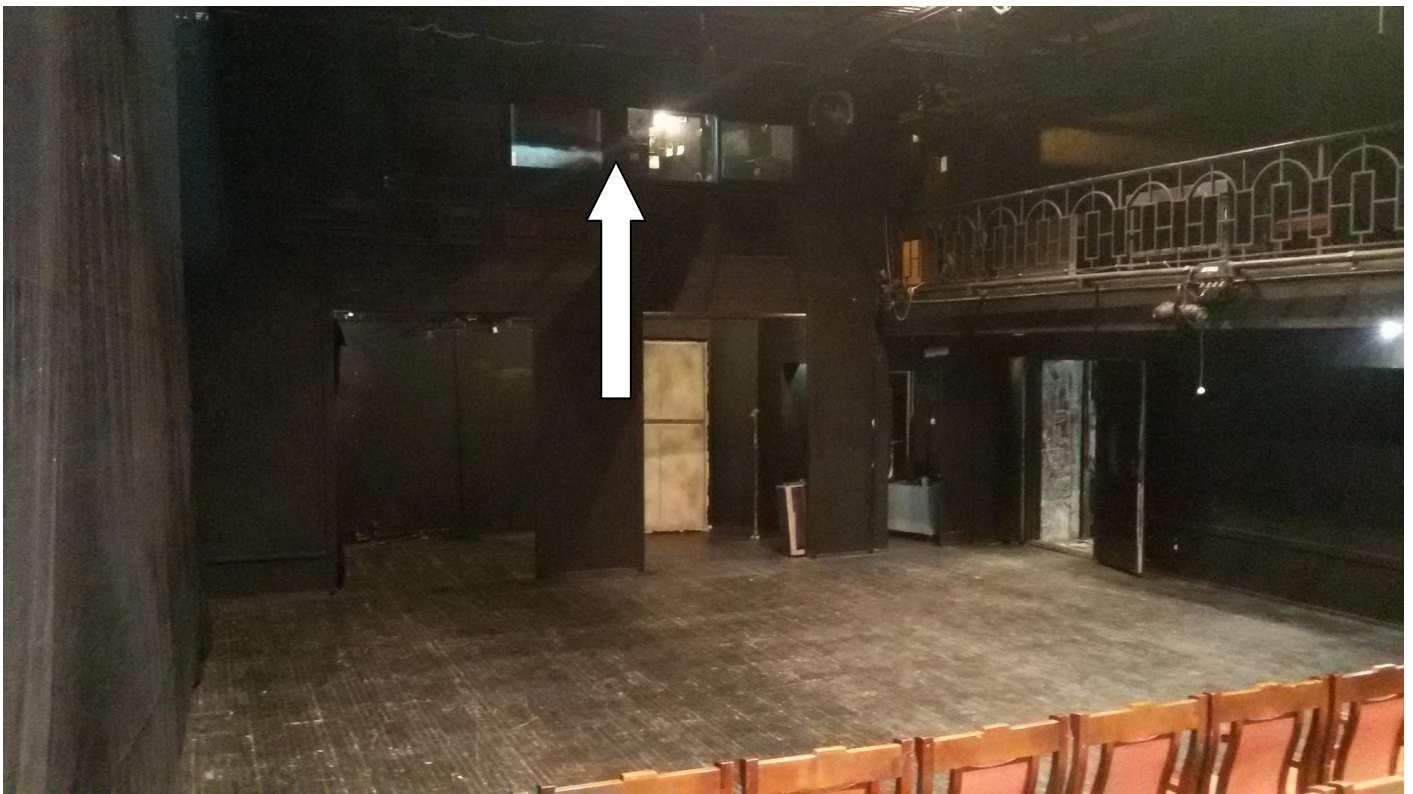

Light operator box and sound operator box shown by arrow.

TECHNICAL DETAILS OF CHAMBER STAGE

«OMSK STATE ACADEMIC DRAMA THEATRE»

1. **Stage dimensions, m**
 - width – 14,3
 - depth – 9,0
2. **Stage floor** – wooden, painted in a black mat color
3. **Height from the stage floor, m**
 - to the grid – 4,8
 - to the floor of the gallery – 2,8
4. **Width of the gallery, m** – 1,7
5. **Number of seats (seats are on a movable platforms 2×1 m)** – max. 100
6. **Sound equipment**
 - sound operator console (ИY3) is on the gallery level above the stage
 - mixing console «ALLEN & HEATH GL 3300» (England):
 - 16 inputs
 - 8 master groups
 - 1 master module
 - amplifier «NEVA» (Russia), pcs. – 3 (275 W each channel)
 - acoustic system «NEXO» PS-8, pcs. – 6 (275 W each channel)
 - processor «t.c. electronic M3000», pcs. – 1
 - number of microphone lines, pcs. – 20 («Canon» type)
 - minidisk «SONY MDS-JB920» with automatic pause, pcs. – 2
7. **Light equipment**
 - light operator console (ИYС) is on the gallery level above the stage
 - console «MIKRON-4D», «Compulite» company (Israel)
 - number of work channels, pcs.:

controlled	– 100 (3 kW each)
uncontrolled	– 16 (3 kW each)
 - apart from the stationary lightning sets indicated in the scheme there are additional connection lines (ЛП) above the grid:
 - on the stage floor (left/right):

controlled	– 9 each
uncontrolled (Hp)	– 3 each
 - on the gallery:

controlled	– 15
uncontrolled (Hp)	– 5
 - in the sound and light operators box:

controlled	– 3
uncontrolled (Hp)	– 1
 - under the sound and light operators box:

controlled	– 3
uncontrolled (Hp)	– 1

- portable equipment:
 - lens spotlight PSL 500 (PC lens) – 10 pcs.
 - spotlight ETC PARNeI 750 – 4 pcs.
 - light scattering spotlight Foton 1000 (asymmetric) – 4 pcs.
 - profile spotlight ETC SF zoom 25°...50° – 4 pcs.
 - light stand (H max = 1,8 m) – 4 pcs.
 - stand – mounted – 4 pcs.

OTHER ROOMS

1. Dressing Rooms

- male (*left side, on the second floor*):

№ 201 – 7 persons,

№ 202 – 3 persons,

№ 203 – 7 persons,

№ 204 – 3 persons,

№ 205 – 4 persons,

- female (*right side, on the second floor*):

№ 230 – 4 persons,

№ 231 – 2 persons,

№ 232 – 2 persons,

№ 233 – 2 persons,

№ 234 – 2 persons,

№ 235 – 8 persons.

2. Work shops:

- decorative, tailoring, joiners, welding and property rooms are in the service part of the theatre
-

PLAN OF CHAMBER STAGE
"OMSK STATE ACADEMIC DRAMA THEATRE"
(M1:100)

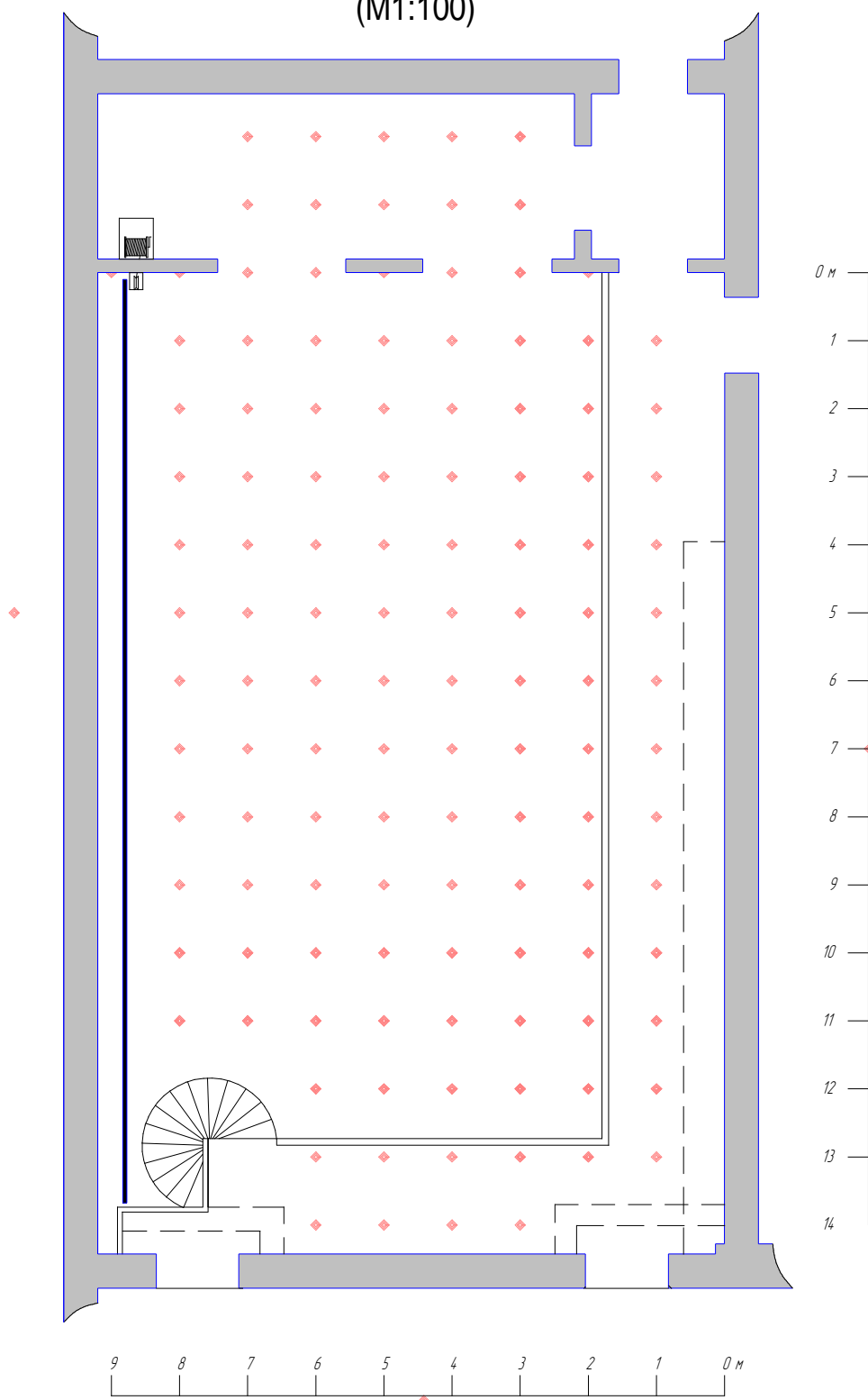

CROSSCUT OF CHAMBER STAGE
«OMSK STATE ACADEMIC DRAMA THEATRE»

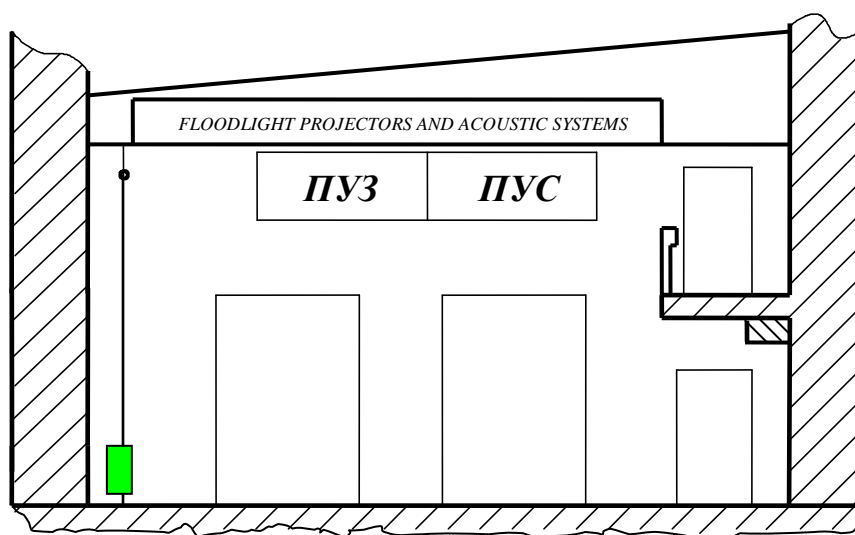

LOCATION OF THE ACOUSTIC SYSTEMS AND MICROPHONE LINES ON CHAMBER STAGE «OMSK STATE ACADEMIC DRAMA THEATRE»

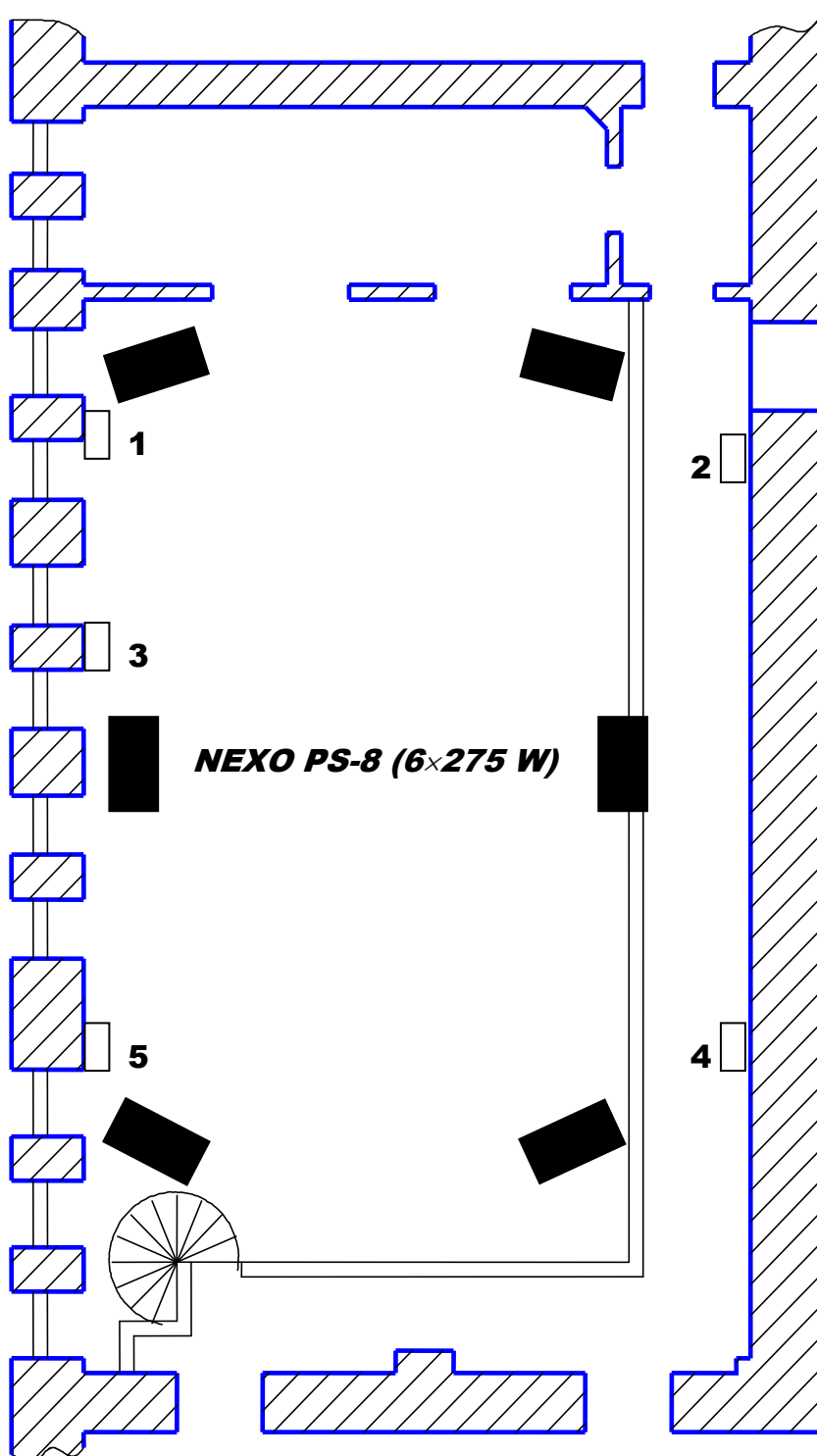

1...5 – 4 microphone lines (each)
«Canon» types

LOCATION OF THE LIGHT EQUIPMENT ON CHAMBER STAGE

"OMSK STATE ACADEMIC DRAMA THEATRE"

(M1:100)

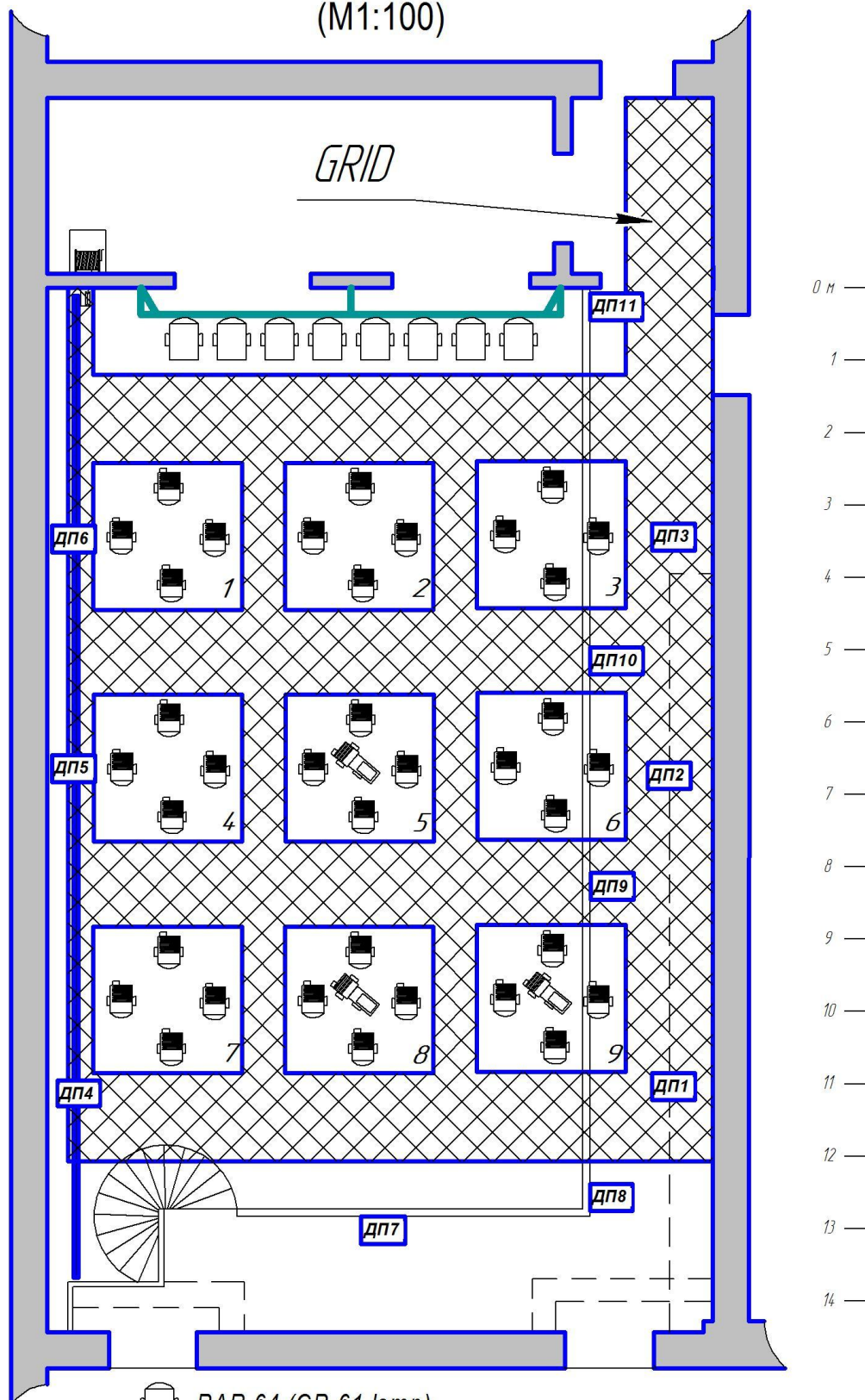

PAR 64 (CP-61 lamp)



SPOT 1000 (PC lens, T-19 lamp)



ETC SF 575 (profile, HPL-575 lamp)

LOCATION OF THE LIGHT EQUIPMENT ON CHAMBER STAGE

«OMSK STATE ACADEMIC DRAMA THEATRE»
(appendix to the scheme)

Location \ Device type	<i>PAR 64</i>	Spot 1000 (PC lens)	ETC SF 575
Grid	8	36	3

CONNECTION NUMBERS ON CHAMBER STAGE

«OMSK STATE ACADEMIC DRAMA THEATRE»
(appendix to the scheme)

<i>Location</i>	<i>Device type</i>	<i>Numbers</i>
On the stage floor:		
ДП1	—	1, 2, 3, Hp
ДП2	—	4, 5, 6, Hp
ДП3	—	7, 8, 9, Hp
ДП4	—	10, 11, 12, Hp
ДП5	—	13, 14, 15, Hp
ДП6	—	16, 17, 18, Hp
On the gallery:		
ДП7	—	20, 21, 22, Hp
ДП8	—	23, 24, 25, Hp
ДП9	—	26, 27, 28, Hp
ДП10	—	29, 30, 31, Hp
ДП11	—	32, 33, 34, Hp
In the sound operator (ПВЗ) and light operator (ПВС) box	—	35, 36, 37, Hp
Under the sound operator (ПВЗ) and light operator (ПВС) box	—	35, 36, 37, Hp
Grid:		
	PAR 64	74...77, 82...85
block 1	Spot 1000 free	70...73 94
block 2	Spot 1000 free	66...69 93
block 3	Spot 1000 free	62...65 92
block 4	Spot 1000 free	58...61 91
block 5	Spot 1000 ETC SF 575	54...57 90
block 6	Spot 1000 free	50...53 89
block 7	Spot 1000 free	46...49 88
block 8	Spot 1000 ETC SF 575	42...45 87
block 9	Spot 1000 ETC SF 575	38...41 86

